

## 1. SET UP INFO TOTEM STRUCTURE



## CONTENT

Open and check the content of the boxes and take out all the pieces carefully.

Hito is made of silver finish aluminium with 3 acrylic shelves for A4 documents. It features a 8kg weight steel base and a double-sided large poster holder.

For setting-up the structure you must place its poster (supplied separately) to the frame following the next steps.

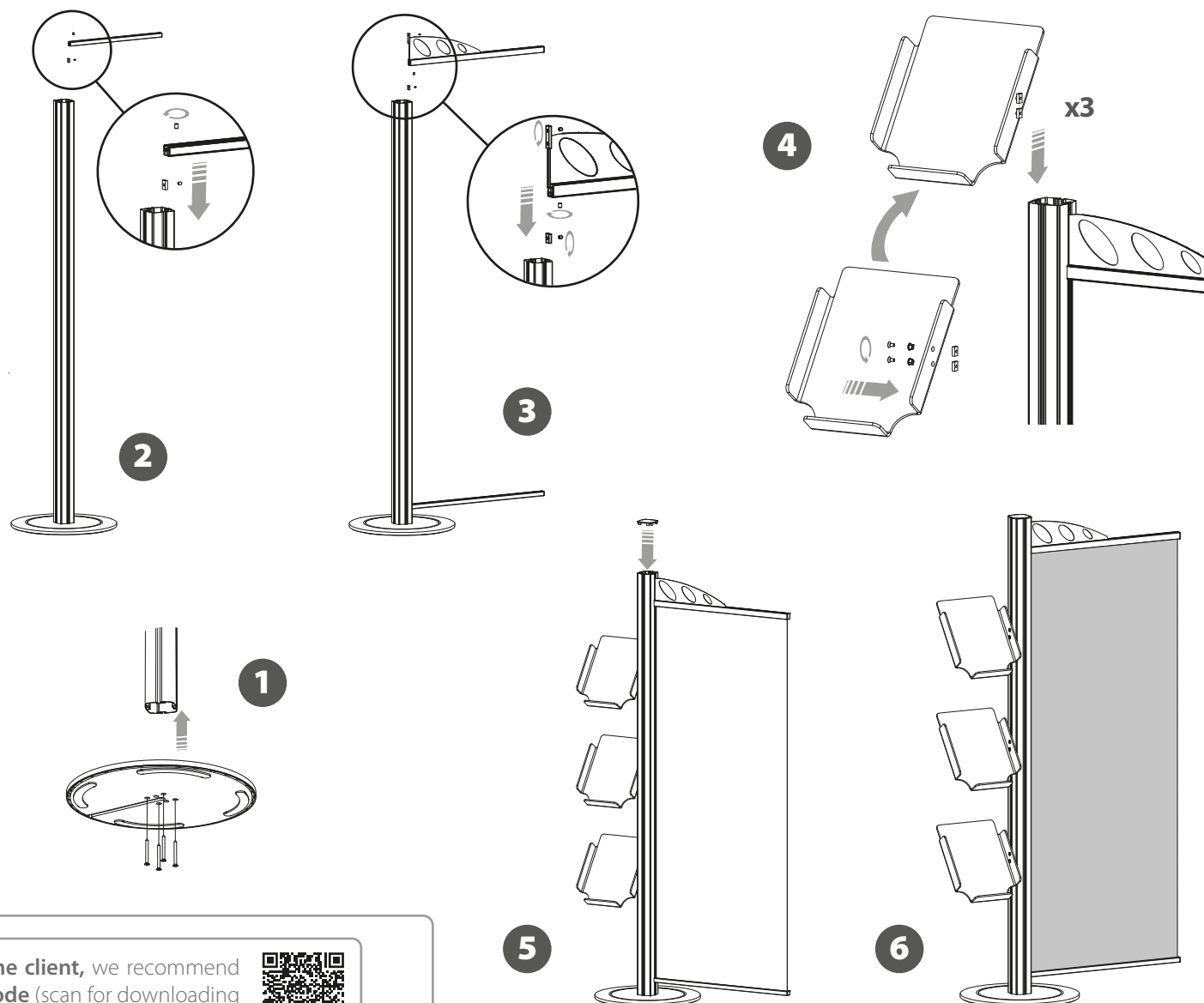
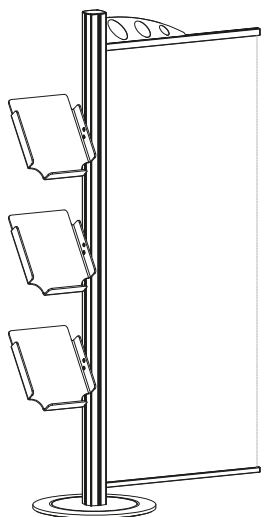

For those cases in which the graphic is **supplied by the client**, we recommend making use of the materials listed in the following **QR code** (scan for downloading Excel file). Please contact us or visit [www.cashdisplay.com](http://www.cashdisplay.com) for more information.

