

1. GRAPHIC + ANTIREFLECTION PROTECTOR PLACEMENT

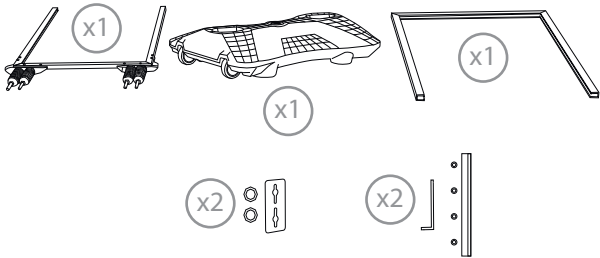

CONTENT



Open and check the content of the boxes and take out all the pieces carefully.

For setting-up the Sidewalk Board, you must place its graphics (supplied separately) to the upper Click Frame following the next steps describe below.

GRAPHIC ATTACHMENT BY CLICK FRAME

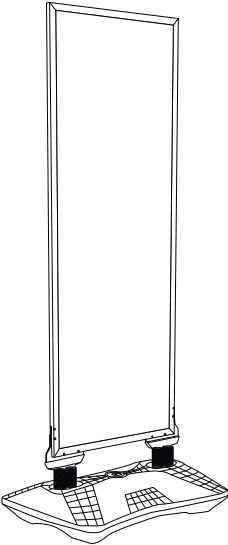
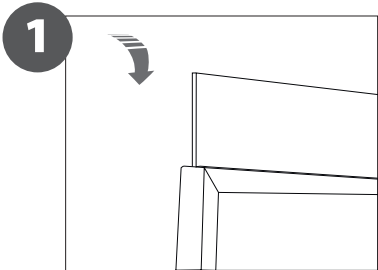

For those cases in which the graphic is **supplied by the client**, we recommend making use of the materials listed in the following **QR code** (scan for downloading Excel file). Please contact us or visit [www.cashdisplay.com](http://www.cashdisplay.com) for more information.



2. SET UP SIDEWALK BOARD STRUCTURE

